

# MobyKit

**For swing gates with leaves up to 3m, surface mounted.**

**Gear motor characteristics:**

- die-cast aluminium monoblock
- patented layout of the internal components: **fewer components means**
- **quick power supply connector**
- **built-in capacitor**
- **moving parts manufactured in solid bronze alloy and metal**

- **slowdown during opening and closing**
- painted, aluminium, Moby key-operated unlock system, **ergonomic and easy to operate**
- **easy adjustment of the limit switches**

**The kit contains:**



**MB4005**

2 electromechanical gear motors, with key release

**N.B.** The content of the package may vary: consult the retailer.



**FL02R-S**

1 transmitter  
433.92MHz,  
2 channels



**A60**

1 control unit A60 with plug-in receiver  
**SMXI**



**MOF**

1 pair of photocells for outdoor installation



**MOSE**

1 key selector switch for outdoor installation



**LUCY**

1 flashing light  
**ABFKIT**  
1 directional aerial



**TS**

signboard

Code	Description	Pack/pallet
<b>MOBYKCE</b>	Kit for automating swing gates with leaves up to 3m, surface mounted	12

Technical specifications

**MB4005**

Power	(Vac 50Hz)	230
Current absorbed	(line) (A)	1.1
Power absorbed	(W)	230
Incorporated capacitor	(µF)	7
Protection level	(IP)	44
Speed	(m/s)	0.016
Travel	(mm)	310
Max thrust	(N)	2000
Working temp.	(°C Min/Max)	-20 ÷ +50
Thermal cut-out	(°C)	140
Work cycle	(%)	30
MobyKit weight	(kg)	20.5

Utilisation limits

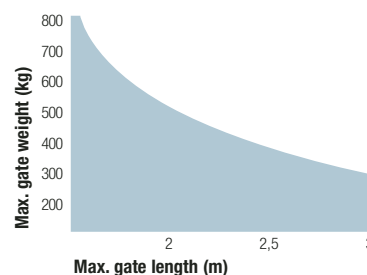

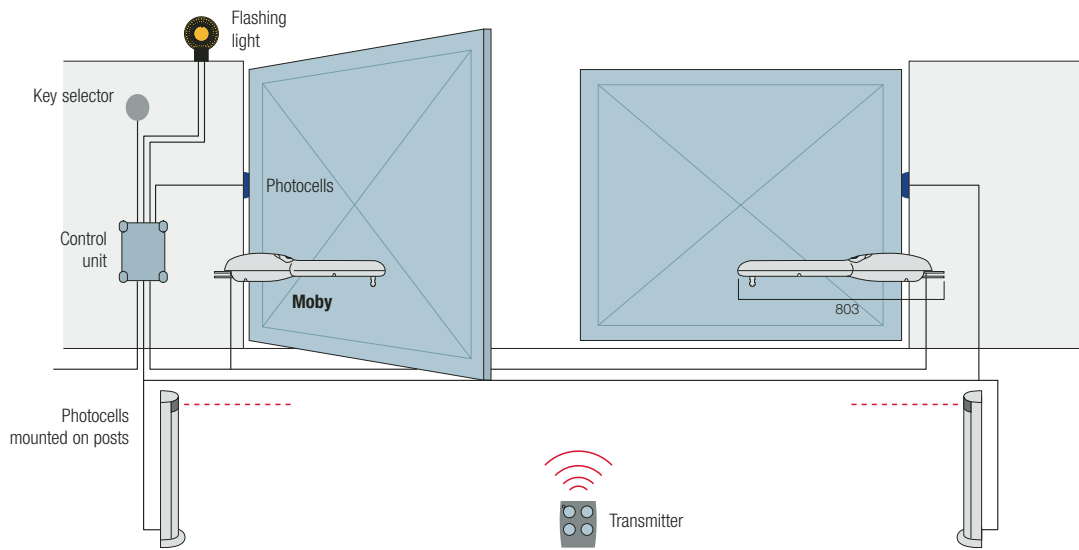

Approximate draft

**Accessories**



**PLA6**  
rear racket 250mm long  
Pc/pack 1



**PLA14**  
screw-adjustable  
rear bracket  
Pc/pack 2



**PLA15**  
screw-adjustable  
front bracket  
Pc/pack 2



**PLA10**  
vertical 12V electric lock  
(required for gates longer  
than 3m)  
Pc/pack 1



**PLA11**  
horizontal 12V electric lock  
(required for gates longer  
than 3m)  
Pc/pack 1



**PLA13**  
travel stops for closing  
and opening manoeuvres  
Pc/pack 4



Nice recommends customers order products in pallets in order to facilitate storage and delivery, and ensure packs are uniform. The number of packs per single pallet has been specified for this reason.