

# WAY SERIES

THE BRUSHLESS AUTOMATED BARRIER  
WITH DIGITAL THINKING

 **ROGER**  
BRUSHLESS

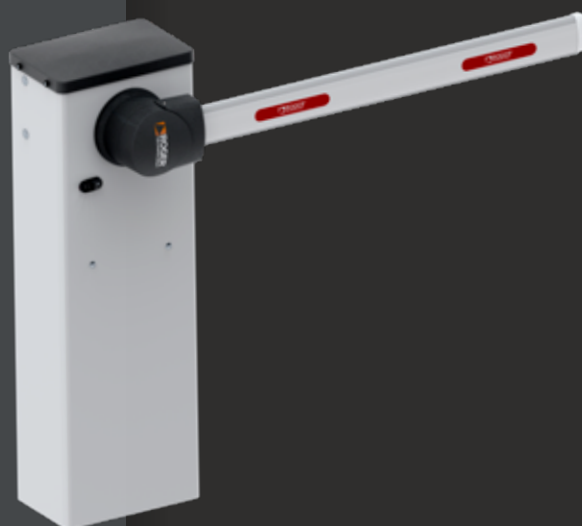

 **ROGER**  
TECHNOLOGY  
100% Made in Italy



# WHAT WE DO

INNOVATION, TOP NOTCH MECHANICS AND NEVER-ENDING TECHNOLOGICAL RESEARCH ARE THE ELEMENTS THAT MAKE ROGER TECHNOLOGY A UNIQUE AND DIFFERENT COMPANY

Starting from our first day of work we immediately gave priority to the development and production of excellent, completely Italian mechanics, based only on top quality ferrous and non ferrous raw materials and guaranteed by impeccable production and surface treatment processes. It was just a few years later, in the 1990s, that we created the first major step in our history, by implementing a mass production line for completely robotised motors, thus becoming a reference outsourcer for major brands of the gate automation market.

## PEOPLE, IDEAS AND PRODUCT EXPERIENCE

From the very beginning **Roger Technology** has evolved and grown because it's people believe that any bright idea can lead to great change in the future. Our people are passionate and innovative in their approach to every challenge, always pushing the boundaries to develop extraordinary products.

In our language we translate the word "**experience**" as passion. It is this passion that drives us in the development of revolutionary **new products** that serve the real needs of our customers. We understand that our customers want a product designed around the way that they work.

**Primo Florian**  
Founding partner  
Engineering  
and design

**Dino Florian**  
Founding President  
Development  
and design

**Renato Florian**  
Founding partner  
Assembly  
and quality



# OUR PLUSES



## EXCELLENT RAW MATERIALS

Steel, ductile cast iron, aluminium, bronze, copper and titanium have always been the main and exclusive raw materials used in the advanced engineering processes of our company.



## PRODUCTION TECHNOLOGY

At Roger Technology all internal manufacturing is carried out on optimised production lines making use of very advanced technology. We have invested heavily in robotics and automated all product manufacturing phases. This ensures that all components and semi-finished products are highly reliable and are fully compliant with our exceptionally high quality standards.



## INTERNAL ASSEMBLY

Our highly qualified and dedicated staff oversee the fitting and assembly stages. Every piece of equipment is checked by our personnel to ensure that we deliver reliable products to our customers.



## MADE IN ITALY

All solutions, products, design and the complete production process of Roger Technology is developed in Italy with the use of materials of primary quality always found in the market through partner suppliers that share the same passion and professionalism of our company in developing products technologically reliable, efficient and simple in the way that they have been made for being installed and used.



# BRUSHLESS MOTOR

A DIGITAL BRUSHLESS MOTOR WITH PERMANENT MAGNETIC FIELD, DIGITAL ELECTRONICS FOR THE COMPLETE MANAGEMENT OF THE AUTOMATION SYSTEM CONTROL. DESIGNED FOR SUPER INTENSIVE USE WITH THE ADDED BENEFIT OF A SUPER LOW POWER CONSUMPTION: **THIS IS ROGER BRUSHLESS**



BRUSHLESS  
MOTOR



DIGITAL  
CONTROLLER



SIMPLE  
INSTALLATION



BLACKOUT  
NO PROBLEM



AMBIENT  
TEMPERATURE



SUPER-INTENSIVE  
USE



ELEGANCE OF  
MOVEMENTS



DIGITAL  
SILENCE



DIGITAL  
ENCODER



REDUCED  
CONSUMPTION



OBSTACLE  
DETECTION



ADVANCED  
ENGINEERING

# AUTOMATIC BARRIER

## WAY SERIES

**WAY/004:** BARRIER WITH INTEGRATED CONTROL UNIT, FOR BOOMS UP TO 4 M

**WAY/005:** BARRIER WITH INTEGRATED CONTROL UNIT, FOR BOOMS UP TO 5 M

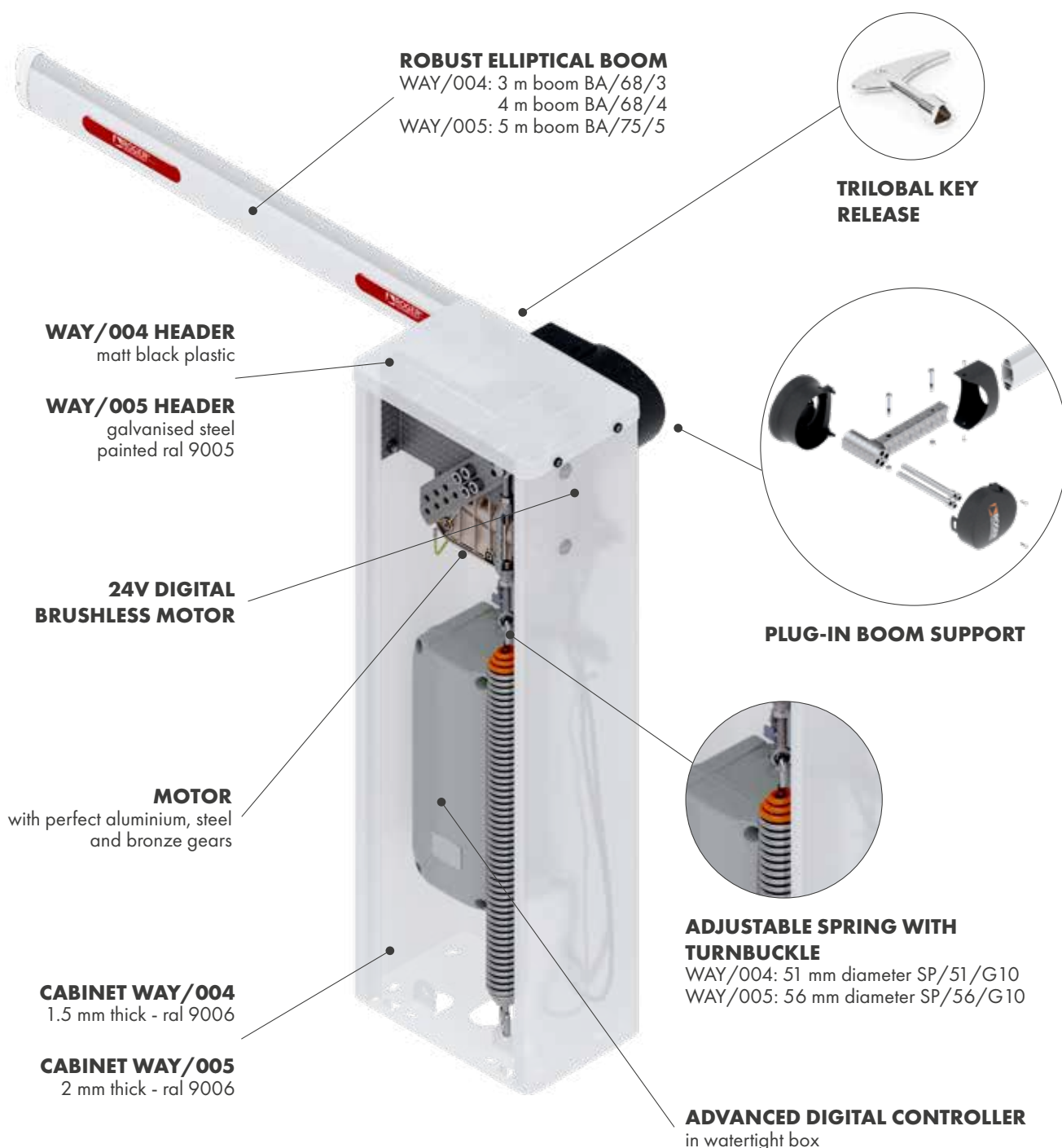

# TECHNICAL SPECIFICATIONS

	WAY/004 - WAY/004/115	WAY/005 - WAY/005/115
<b>DESCRIPTION</b>	Barrier BRUSHLESS for booms up to 4 m, with control unit and and SENSORED digital magnetic encoder at 4096 PPR, complete with fixing plate with tie rods, screws boom fixing flanges. Also available with 115 V line power supply.	Barrier BRUSHLESS for booms up to 5 m, with control unit and and SENSORED digital magnetic encoder at 4096 PPR, complete with fixing plate with tie rods, screws boom fixing flanges. Also available with 115 V line power supply.
<b>DRIVE TYPE</b>	IRREVERSIBLE	IRREVERSIBLE
<b>MAINS POWER SUPPLY</b>	WAY/004: 230 V~ - WAY/004/115: 115 V~	WAY/005: 230 V~ - WAY/005/115: 115 V~
<b>VOLTAGE FROM THE CONTROL UNIT TO THE BRUSHLESS MOTOR</b>	24 V~, variable frequency	24 V~, variable frequency
<b>INVERTER DRIVEN MOTOR</b>	field-oriented (FOC), sensed with high-resolution encoder	field-oriented (FOC), sensed with high-resolution encoder
<b>MAXIMUM POWER ABSORBED</b>	180 W	180 W
<b>STARTING POWER</b>	305 W	305 W
<b>STARTING TORQUE</b>	140 Nm	140 Nm
<b>MAXIMUM TORQUE (SERVICE S3 70%, -20°C +55°C)</b>	56 Nm (@1500 1/min) (*)	56 Nm (@1500 1/min) (*)
<b>NOMINAL TORQUE (SERVICE S1 100%, -20°C +55°C)</b>	49 Nm (@ 1500 1/min)	49 Nm (@ 1500 1/min)
<b>MANOEUVRING TIME</b>	4-12 s	5-17 s
<b>BOOMS LENGTH</b>	up to 4 metres	up to 5 metres
<b>OPERATING CYCLES (INTERNALLY TESTED)</b>	500000 (**)	500000 (**)
<b>NUMBER OF OPERATING CYCLES PER DAY (INTERNALLY TESTED)</b>	4500	2800
<b>USE</b>	INTENSIVE (with nominal torque)	INTENSIVE (with nominal torque)
<b>RELEASE SYSTEM</b>	trilobal key	trilobal key
<b>GRADE OF PROTECTION</b>	IP54	IP54
<b>WORKING TEMPERATURE</b>	-20 °C / +55 °C	-20 °C / +55 °C
<b>SOUND PRESSURE DURING USE</b>	<70 dB(A)	<70 dB(A)
<b>OPERATOR WEIGHT</b>	40 kg	44 kg
<b>FORCE TO BE APPLIED ON THE MECHANICAL</b>	10 N	10 N
<b>CONTROL UNIT</b>	B70/1T	B70/1T



Brushless Motor



Intensive Use



High Speed Motor



Reversible Motor

(\*) Driving torque that allows operation with duty-cycle 70%, at the speed in RPM indicated in the table (1/min equals RPM), at an ambient temperature of +55°C; the speed is also expressed in degrees of rod rotation per second, but it must be considered that the movement of the rod is subject to an acceleration phase at the start and a deceleration phase at the finish, which prolongs the overall duration of the stroke.

(\*\*) Internal test verified at nominal values on 4 and 5 m rods at an ambient temperature of 20°C. The value shown is NOT the maximum value.

## KIT PACKAGING

L.: 24,1 cm

P.: 34,7 cm

H. 106,6 cm





# FUNCTIONS

## OF WAY BARRIERS

DESCRIPTION	WAY/004 - WAY/004/115	WAY/005 - WAY/005/115
BOOM LENGHT	UP TO 4 M	UP TO 5 M
ONBOARD DIGITAL CONTROLLER	B70/1T	B70/1T
RADIO RECEIVER TYPE	H93/RX20/I and H93/RX22A/I with fixed code connection H93/RX2RC/I with rolling code connection	H93/RX20/I and H93/RX22A/I with fixed code connection H93/RX2RC/I with rolling code connection
MOTOR POWER SUPPLY	24V DC	24V DC
MOTOR MANAGEMENT TECHNOLOGY (ETC)	SENSORED technology	SENSORED technology
ENCODER TYPE	Magnetic Digital SENSORED, 4096 PPR	Magnetic Digital SENSORED, 4096 PPR
MAINS POWER SUPPLY	WAY/004: 230V AC - 50 Hz WAY/004/115: 115V AC - 60 Hz	WAY/005: 230V AC - 50 Hz WAY/005/115: 115V AC - 60 Hz
BATTERY OPERATION	√ - B71/BC/EXT to be installed outside the cabinet	√ - B71/BC/EXT to be installed outside the cabinet
ENERGY CONSUMPTION	Very low consumption	Very low consumption
MASTER / SLAVE FUNCTION	-	-
NUMBER OF MOTORS	1	1
POWER SUPPLY FOR ACCESSORIES	24V DC	24V DC
FLASHING LIGHT BARRIER TYPE	-	-
FLASHING LIGHT BOOM TYPE	24V DC LED - led strip, red light only, length 4 m (ALED/4C)	24V DC LED - strip led, red light only, length 6 m (ALED/6C)
TRAFFIC LIGHT MANAGEMENT BOOMS AND FLASHING LIGHTS	-	-
OUTPUT FOR BARRIER OPENING INDICATOR AND AUTOMATION SYSTEM ON WARNING LIGHT	√	√
OUTPUT FOR COURTESY LIGHT	40W	40W
TIMED AND GUARANTEED AUTOMATIC CLOSING	√	√
GATE EDGE SAFETY MANAGEMENT 8,2KΩ OR STANDARD	√	√
LIMIT SWITCH TYPE	Mechanical stop adjustable in opening and closing	Mechanical stop adjustable in opening and closing
FORCE ADJUSTMENT IN NOMINAL MOVEMENT	√	√
FORCE ADJUSTMENT IN START-UP AND DECELERATION	√	√
OBSTACLE DETECTION - MOTOR REVERSAL	√	√
OPENING AND CLOSING SPEED SETTING	√	√
DECELERATION DURING OPENING AND CLOSING	√	√
OPENING AND CLOSING APPROACH DISTANCE SETTING	√	√
STARTING ACCELERATION (SOFT-START) FOR OPENING AND CLOSING MANOEUVRES	√	√
SAFEGUARDED CLOSURE/OPENING FUNCTION	√	√
STOPPING SPACE AND MOTOR BRAKING	√	√
HUMAN PRESENCE CONTROL	√	√
CONDOMINIUM FUNCTION	√	√
SAFETY DEVICE CONFIGURATION	√	√
INSTALLATION TEST FUNCTION	(prog button)	(prog button)
OPERATING TEMPERATURE	-20°C/+55°C	-20°C/+55°C
INVERTER THERMAL PROTECTION	√	√
MAGNETIC ELECTRO-LOCK MANAGEMENT	-	-
DETECTOR LOOP MANAGEMENT	-	-
CLOCK FUNCTION (INCLUDED)	√	√
PARKING ACCESS MODE FUNCTION	-	-
EXTERNAL STATUS TYPE OUTPUT SETTING	-	-
RESTORE FACTORY DEFAULT VALUES	√	√
INFORMATION ON USE OF MOTOR	√	√
SECURITY PASSWORD MANAGEMENT	√	√
ENABLING OF ANTI-BREAKING THROUGH SYSTEM	-	-

# INSTALLATION

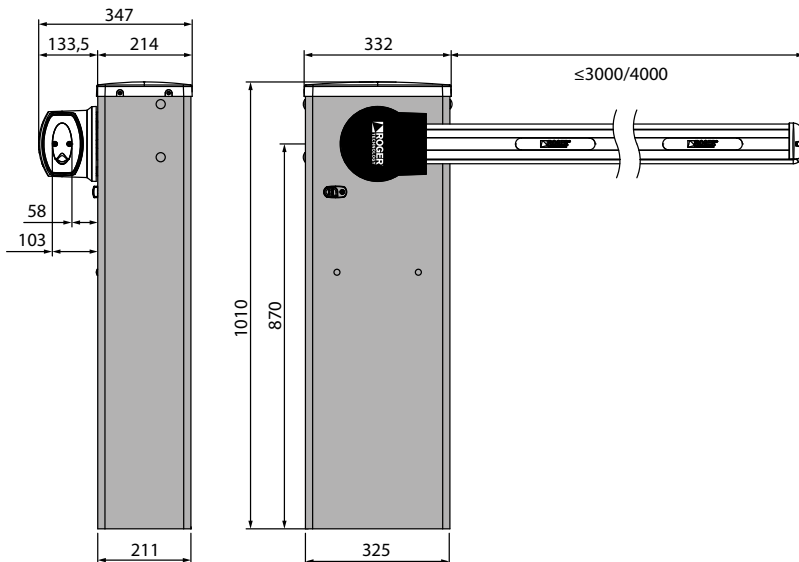

## DIMENSIONS WAY/004

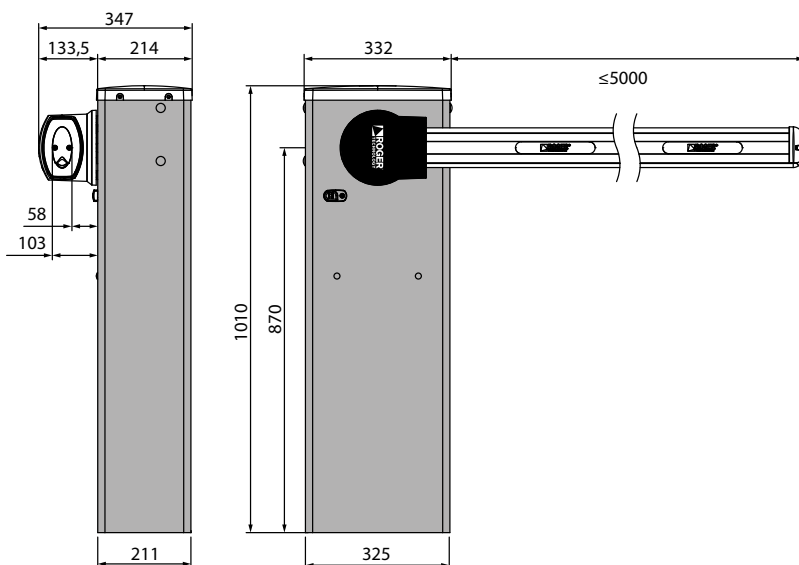
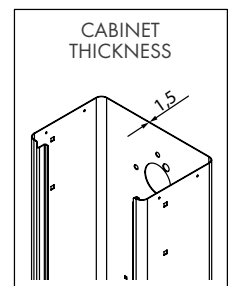
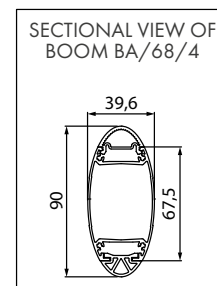

## DIMENSIONS WAY/005

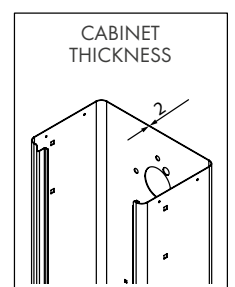
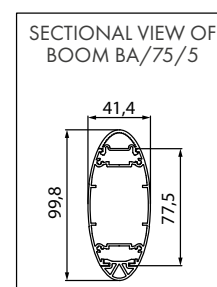

## DIMENSIONS KT251 (INCLUDED)

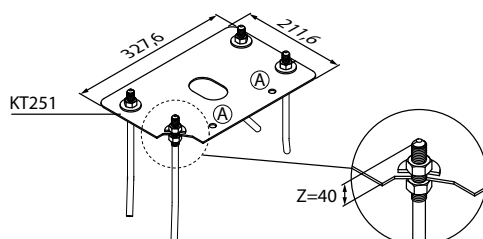

Note: all measurements in the drawings are in millimetres



# INSTALLATION TYPE



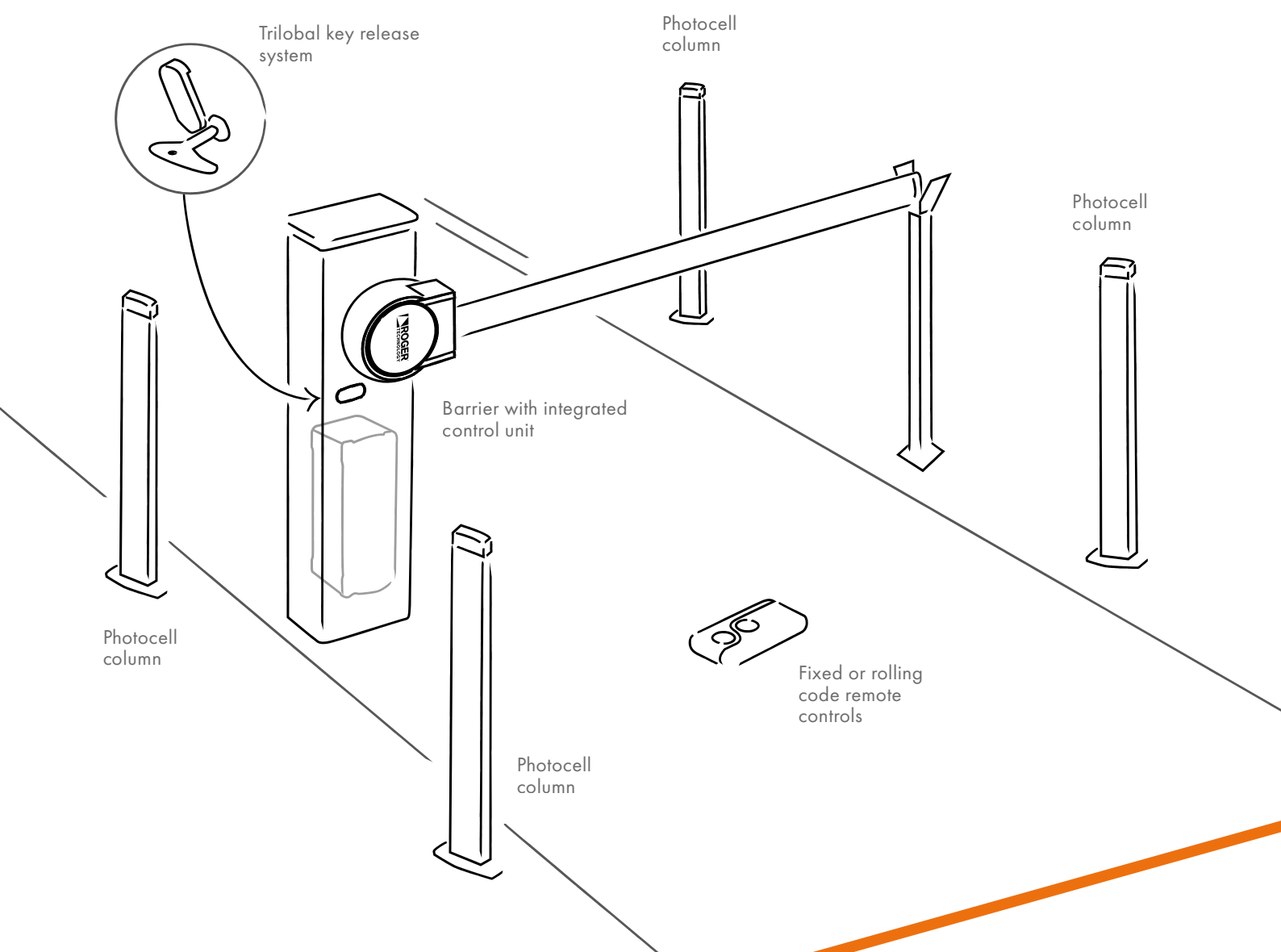

A PRACTICAL EXAMPLE FOR YOUR SUCCESSFUL INSTALLATION







# OPTIONAL ACCESSORIES

WAY: EVERYTHING YOU NEED FOR A COMPLETE,  
PROFESSIONAL INSTALLATION

## ACCESSORIES FOR WAY/004

	<b>ALED/4C</b>	 <b>RED LIGHT</b>	4-metre LED strip with connection cable for barrier boom (red colour)
	<b>BA/68/3</b>		White painted aluminum boom, 3 meters long, with LED cover profile and impact resisteng rubber profile
	<b>BA/68/4</b>		White painted aluminum boom, 4 meters long, with LED cover profile and impact resisteng rubber profile
	<b>SP/51/G10</b>		Orange spring Ø51

## ACCESSORIES FOR WAY/005

	<b>ALED/6C</b>	 <b>RED LIGHT</b>	6-metre LED strip with connection cable for barrier boom (red colour)
	<b>BA/75/5</b>		White painted aluminum boom, 5 meters long, with LED cover profile and impact resisteng rubber profile
	<b>SP/56/G10</b>		Purple spring Ø56

## ACCESSORIES FOR WAY/004 AND WAY/005

	<b>B71/BC</b>	Batteries charger for Brushless digital controller B70/1DC - B70/1T
	<b>B74/BCONNECT VERS. HW2</b>	Module WI-FI B-CONNECT - Remote management and programming system in IP web browser mode via Wi-Fi hot spot P2P connection for Brushless control units (B70/2ML - EDGE1 - CTRL - B70/1DC - B70/1DCHP - B70/1T - B70/1THP - F70/IPU36)
	<b>BAFS/01</b>	Fixed support with rubber, not adjustable, for booms
	<b>BAFS/02</b>	Fixed support with rubber, adjustable telescoping, for booms
	<b>BAFS/03</b>	Fixed support with rubber, not adjustable, with predisposition for bolt, for booms
	<b>BAFS/04</b>	Fixed support with rubber, adjustable telescoping, with predisposition for bolt, for booms
	<b>BAMS/01</b>	Mobile support for bars
	<b>BAMS/01/EXT</b>	Extension 20 cm for mobile support BAMS/01
	<b>BARK/02</b>	Painted aluminum skirting, with stainless steel screws mounted on bronze bushings. Single module length 2 meters
	<b>CRA/BAR</b>	Column for photocells G90/F2ES - G90/F4ES for spaced installation on a barrier cabinet (+23 cm)
	<b>CRA/BAR/M90</b>	Column for photocells M90/F2ESO - M90/F4ESO for spaced installation on a barrier cabinet (+23 cm)
	<b>DLD1/24</b>	Loop detector for 1 loop, 2 output, 24V AC/DC
	<b>DLD2/24</b>	Loop detector for 2 loops, 2 outputs + output alarm, 24V AC/DC
	<b>HT418</b>	External box without batteries, for battery BT12V45 (12V DC 4,5 Ah)
	<b>KT231</b>	Fixing plate for fixed supports codes BAFS/01, BAFS/02, BAFS/03, BAFS/04, BAFS/05
	<b>R99/BASB20</b>	Pack of 20 stickers for barrier

**PREMIUM DEALER / PROFESSIONAL DEALER**



imaginative ASSOCIATI



F99/E/019EN - 04/2025



Via S. Botticelli, 8  
31021 Bonisiolo di Mogliano Veneto (TV) · ITALY  
T. +39 041 5937023 · F. +39 041 5937024  
**WWW.ROGERTECHNOLOGY.COM**

