

CL8-GSM-N/NC Instruction

I.Overview

①Front view

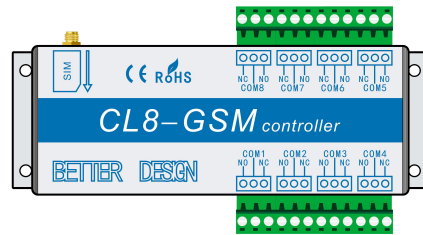

②Side elevation

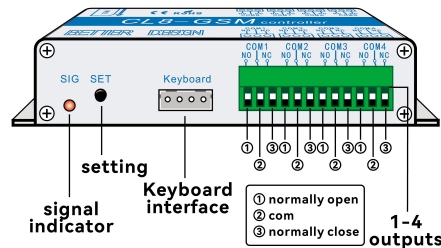

master numbers. Master numbers with a power-down memory function.

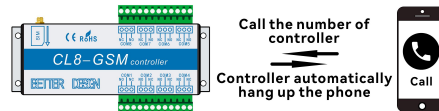

6.How to control GSM controller: SMS/Dial/ Button

6.1.SMS(ON /OFF/COM Command. T Command. L Command. XT Command)

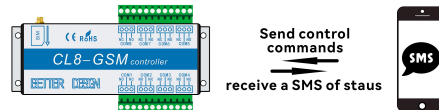

Setup steps: (the default password is 0000)
6.1.1 ON Command turn the relay state to all ON.
SN+PASSWORD+ON
e.g. Send: **SN0000ON**; then receive: **STATE IS ALL ON; No sensor**

6.1.2 OFF Command turn the relay state to all OFF
SN+PASSWORD+OFF
e.g. Send: **SN0000OFF**; then receive: **STATE IS ALL OFF; No sensor**

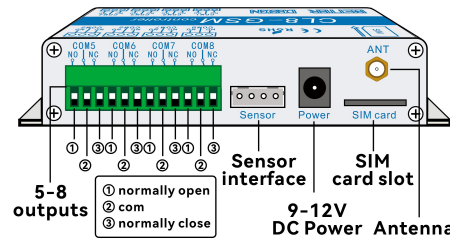

II .Key and Indicator

| | |
|------------|--|
| SET button | press the SET button, you can manually set the master number |
| SIG button | GSM signal indicator ,flash two seconds to enter the GSM network |

III .Options

1.Insert SIM card

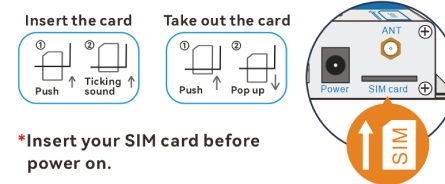

6.1.3 COM command (control state of each pathway)

SN+password+COM+control code
(control code description: **N**:on **F**:off **X**:ignore)
e.g.Send **SN0000COMNNFFFFF**,indicates that turn the 1th and 2th relays to on,turn other 6 relays to off. Operation successfully the controller will reply: **SW1-8:NNFFFFF; T:+23.8 C**

6.1.4 T Command trigger the relay (switch status in short time and then reinstate,the time can be set)

SN+PASSWORD+T+*+C/X(*:0-9,is trigger time. 0 is 0.5 second; 1-9 is 1-9 second)
(**C**:trigger;**X**:ignore)
e.g.(SW1:0.5 second trigger, SW2 ignore, SW3 ignore, SW4 ignore,SW5 ignore,SW6 ignore,SW7 ignore,SW8 ignore): **SN0000T0CXXXXXX**; SMS reply:**SW1 IS trigger**

6.1.5 L Command trigger the relay state for a long time

(change state in long time and reinstate,the time can be set)
SN+PASSWORD+L+*+C/X** (***:001-240, 001 is 1 minute; 240 is 240 minutes)
(**C**:trigger;**X**:ignore)

Note: Up to 240 minutes timing can be timed, this command can be use to timing.

2.Power supply



3.Connecting the GSM net-work

The SIG light is on when the power is connected,controller will connecting the GSM network when SIG become flash 2 seconds after a short initialization time(about 50 seconds).If SIG Flashing 2 seconds you can set and control the GSM controller.



4.Set password

Factory default password of controller: 0000
controller default password is:0000. Password contents 0-9 Arabic numerals(not letters or symbols), otherwise it will prompt an error), Set numbers password command format: **SN + password(4 numbers) + NEW + new password**.

For example, customers want to set their password to be "1234", then he should edit the message content: "**SN0000NEW1234**" issued to controller, if you set successfully, you will receive

e.g. When you want timing 2 hours for a Rice cooker(SW1), and SW2-8 ignore. First GSM controller initial state is OFF, you send SMS: **SN0000L120CXXXXXX**, then the state turn to ON and you will receive a SMS : **SW1 IS trigger**. The ON state will be kept 120 minutes, after 120 minutes state turn to OFF.

6.1.6 Set the dial control funtion. (XT Command)

set the trigger mode of dial and trigger time:
SN+password+XT+*
(*:0-9,is trigger time. 0 is 0.5 second; 1-9 is 1-9 second).cancel the trigger mode of dial:
SN+password+XTC

e.g.when you want to trigger 5 seconds by dial control, send: **SN0000XT5**,and you receive: **JOG FUNCTION IS ON**. In this mode, state will trigger 5 seconds, when the master number dial . this mode with a power-down memory function.

when you want to cancel the trigger mode,send: **SN0000XTC** receive: **JOG FUNCTION IS OFF**. if the trigger mode has be cancelled, the state will be change when the master number dial. and this mode is default.

6.2.dial to control

After setting the master number by SMS(if without master number, the controller can not be controlled by dial)e.g if device is off now, when you call the controller device will turn to on and hang up.

the message:" **SN SET OK NEW SN IS 1234** (New password)." The password is equipped with the memory function.

5.Set master number(can set up 10 groups)

There are two ways to set master numbers : one way is SMS another is by dial

5.1.SMS setting mode

Set the master number command fomat:
SN+PASSWORD+SET+master number(Phone number)

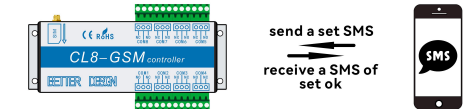

e.g. passwords is 0000, customers want to set 13788889999 to be master number,and then edit the SMS: **SN0000SET13788889999** issued to GSM controller, if you set successfully will receivea message: **13788889999SET OK**. GSM controller can only be controlled by the master numbers Master numbers with a power-down memory function.

5.2.DAIL setting mode

e.g. Press the SET button for 3 seconds,SIG led will fast flash for 30 seconds, during this time which number dial controller, controller will automatically hang up thedial phone, and then the dial number will become

e.g if device is off now, when you call the controller, device will trigger (turn to on some time and turn to off) and hang up.

Use TXC command you can return to default mode. send: **SN0000TXC**, receive :**JOG FUNCTION IS OFF**. This mode is default.

If you want to receive a feedback SMS from controller when you dial control. you can send **SN0000CBO** to activate this function.

send: **SN0000CBC** to close the feedback SMS by dial.

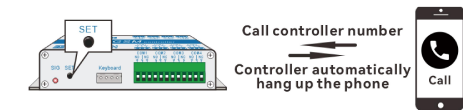

6.3.Button control

Keyboard:

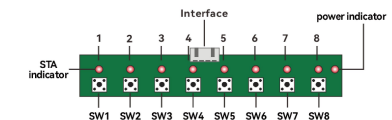

Keyboard connector:



You can use an external keyboard to manually control the output of the device

6.4.Temperature control (up to 8 groups)

6.4.1 Setting temperature control

Format:SN+password+LE/GR(LE is less than,GR is greater than)+Group number(01-08)+P/N(P for +,N for -)+****(****is the hundreds, tens, ones and decimal places of temperature)+N/F/X(N for ON,F for OFF, X for ignore)

e.g. Send: **SN0000LE01P0250NNNNNNNN**

Equipment to reply: **T02:LE +25.0C SW1-8:NNNNNNNN**

SW1-SW8 will all turn to on when the temperature is below +25.0 degrees.

e.g. Send: **SN0000GR02N0030XXXNNFF**

Equipment to reply: **T02:GR -3.0C SW1-8:XXXXNNFF**

When the temp is above -3 degrees,SW1-SW4 will be ignored,SW5-SW6 will turn to ON and SW7-SW8 turn to OFF

6.4.2 Delete temperature control

Format:SN+password+DET+***(**for the Group number)

e.g. When you want to delete the first group,Group number is 01, Edit short messages : **SN0000DET01**. When you want to delete second group,Group number is 02, Edit short messages : **SN0000DET02**.

8.How to set SMS feedback when power on or off:

* only for CL8-GSM-NC

SN+PASSWORD+DL+O/C [O is letter]

Cancel SMS feedback: SN0000DLC [Default function]

If you want receive a feedback SMS after power on or off, you can send: **SN0000DLO**, receive:

REMIND NUMS:

1:+8613099999999

2:+8615899999999

3:

4:

Power on remind SMS:equipment is powered on.

Power off remind SMS:equipment is powered off.

9.CHECK command for check the controller status

SN+Passwords +CHECK(SN**CHECK)**

10.Memory function of controller power down

The default function of controller is power down save. Status can be determined by observing the SIG lights flashing after power on: After power SIG flash two times, which means that the status is power down save; SIG after power flash four times, which means that the status is without power down save.

6.4.3 Check temperature control

Format:SN+password+GTS+***(**is group number,you can check 4 temperature groups by one SMS)

e.g. check the 1-4 groups,SMS:**SN0000GTS01**,by the same way,to check the 5-8 groups,SMS: **SN0000GTS05**

6.4.4 Temperature correction

Format : **SN+password+CT+P/N(P:Increase temperature,N:Reduced temperature)+**(**:00-50,The minimum until is0.1 degrees)**

e.g.**SN0000CTN10**, You will receive SMS:**CT** value is -1.0 degrees (it means the temperature will be reduced 1.0 degreesto be the correction number)

e.g.**SN0000CTP22**, You will receive SMS:**CT** value is +2.2 degrees(it means the temperature will be increase 2.2 degreesto be the correction number)

6.4.5 Set the temp/humidity trigger SMS notification

Format:**SN+password+TLO**
Cancel SMS feedback: **SN0000TLC** [default function]

If you want to receive a SMS when the temp/humidity trigger, you can send: **SN0000TLO**, receive: **TEMP LINKAGE NUMS:**

1:+8613099999999

2:+8615899999999

3:

4:

For example: power down status can be changed by the customer, press SET for 10 seconds and release, you can change the current memory status.

11.Reset the system

Press SET key for 30 seconds and release, you can observe SIG led flash 5 times and reset the controller.The master numbers will be deleted and the password renew to 0000 when you set successfully.

12.MODE1 is default mode (works in most countries)

When you are in the Nordic Europe or other a few countries found call works but SMS did not respond, change to MODE0.

e.g. Send SMS: **SN0000SM0** to equipment, then receive: **MODE0 SET OK**. When you want to change to MODE1, sendSMS: **SN0000SM1**

13.KT command

(set the phone number length of feedback SMS)

The KT mode is closed in default.When you are not receive the feedback SMS in some situations.

Try to set KT Mode to solve this problem.

SN+password+KT+length of country code+ S

+country code+ L +length of number

country code:For example,France country code is 33; Russian country code is 7.Length of phone number in France is 9 e.g 646370491.Length of phone number in

e.g. Equipment linkage: **H01:GR 50% SW1-**

8:NFFNNNNN When the humidity is higher than the setting value, the linkage is triggered and you will receive: **1st humi group: 051% is higher than the preset humi 050%, SW1-8:NFFNNNNN**

6.5.Humidity control (up to 8 groups)

6.5.1 Setting humidity control

Format:SN+password+LE/GR(LE is less than,GR is greater than)+group number(01-08)+H+*** (***is the hundreds, tens, ones places of humidity)+N/F/X(N for ON,F for OFF, X for ignore)

e.g.Send: **SN0000LE01H068NNNNNNNN**

Equipment to reply:**H01:LE 68% SW1-8:NNNNNNNN**

The SW1-SW8 will all turn to ON when the humidity is below 68%.

e.g.Send: **SN0000GR02H088FFFFNNNX**

Equipment to reply: **H02:GR 88% SW1-8:FFFFNNNX**

When the humidity is above 88%,SW1-SW4 will turn to OFF,SW5-SW7 will turn to ON and ignore the SW8.

6.5.2 Delete humidity control

Format:SN+password+DEH+***(**for the Group number)

e.g. When you want to delete the first group,Group number is 01, Edit short messages :

Russia is 10 e.g 9177022528.

Example 1(in France):if you set the country code to 33, then **SN0000KT2S33L09**,if 0033 then **SN0000KT4S0033L09**

Example 2(in Russia):if you set the country code to 7, then **SN0000KT1S7L10**,if 007 then **SN0000KT3S007L10**

If you receive feedback SMS: **SET OK**, your setup is successful.

If you want to close this mode, send:

SN0000KTC,then you will receive: **KT MODE IS CLOSE**

SN0000DEH01.

When you want to delete second group,Group number is 02, Edit short messages : **SN0000DEH02**.

6.5.3 Check humidity control

Format:SN+password+GHS+***(**is group number, you can check 4 humidity groups by one SMS)

e.g. check the 1-4 groups,SMS:**SN0000GHS01**,by the same way,to check the 5-8 groups ,SMS: **SN0000GHS05**.

6.5.4 Humidity correction

Format : **SN+password+CH+P/N(P:Increase temperature, N: Reduced humidity)+**(**:00-20%, The minimum until is 1%)**

e.g. **SN0000CHN10**, You will receive SMS:**CH value is-10%**(it means the humidity will be reduced 10% to be the correction number)

e.g. **SN0000CHP05**,You will receive SMS:**CH value is +5%**(it means the humidity will be increase 5% to be the correction number)

7.dial control receive feedback SMS.

set feedback SMS: **SN+password+CBO** [O is letter]

cancel feedback SMS: **SN+password+CBC** [This function is default]

In the default mode, no SMS will be received after dial control.If you want to receive a feedback SMS after dial control, you can send: **SN0000CBO** to GSM controller, receive: **MESSAGE FUNCTION IS ON**